

Site Development Plan

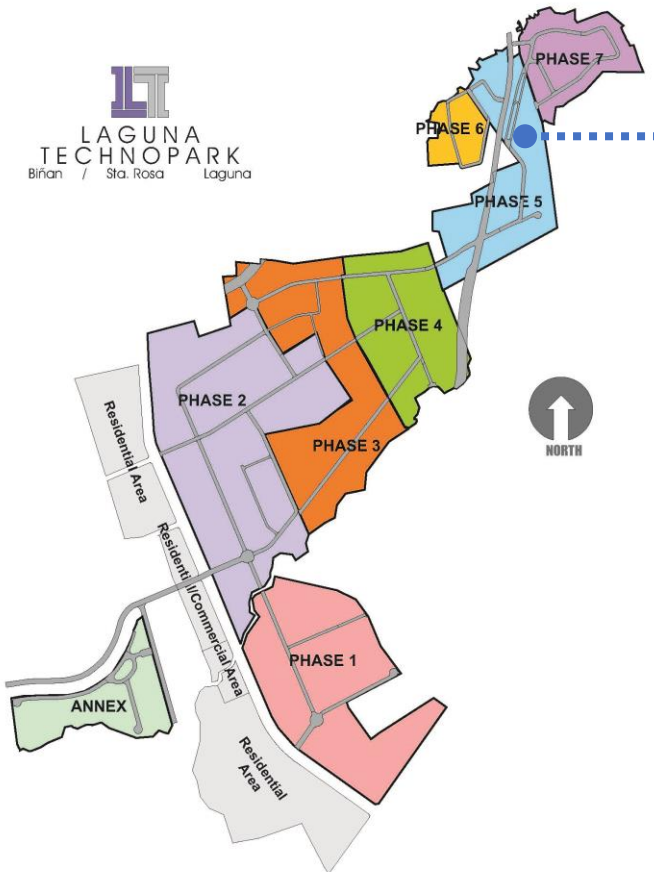

**LAGUNA
TECHNOPARK**
Biñan / Sta. Rosa / Laguna

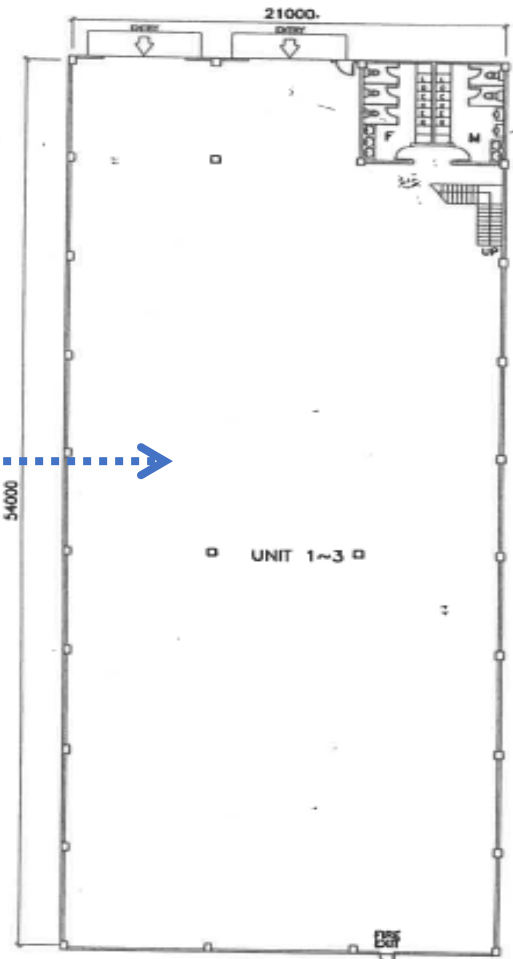

GROUND FLOOR LAYOUT

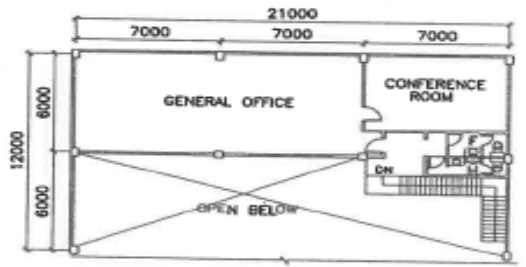

SECOND FLOOR LAYOUT

TYPICAL PLAN
UNIT 1~3

Building Specifications

FEATURES	DETAILS
Land Area	11,327 square meters
Gross Leasable Area (Building)	5,578 square meters (8 units) Ground Floor: 462 – 1,092 square meters Mezzanine: 126 square meters Genset House: 28 square meters Parking: 42 square meters, 3 slots per unit
Floor Load	1 ton / square meter
Ceiling Height Production Office	7.60 meters 2.60 meters
Power Supply	Prepared at maximum of: 500 KVA power at 220 volts or 1000 KVA at 440v (Units 1, 2 and 3) 300 KVA power at 220 volts or 600KVA at 440v (Units 4 and 5)
Water Supply	Industrial and Domestic supply from local utility provider
Used Water	Tap to existing Centralized Sewage Treatment plant by local utility provider

Building Specifications

FEATURES	DETAILS
Genset House	Provision for a Genset house of approximately 28 square meter
Fire Protection	Centralized Water Cistern with motor pump, Wet Stand pipe, Siamese Connection Fire Alarm Notifier , FDAS
Fire Wall	Fire wall provided at every units
Ventilation	Roof ventilators
Loading Bay	Each loading bay with: -4 m (width) x 4 m (height) roll up doors
Others	Perimeter fence (with perimeter lights) – 2 meters in height 0.5 meter CHB plus 1.5 meter metal grills fence (front) Two Guard Houses – 1 for entrance and 1 for exit with an area of 2m x 2m each Entrance/Exit sliding gates – five (5) meters each gate Ceiling: Office area: Non-sag acoustic board on oven baked t-runners